

MS Monet

4 anchors - Danube and Rhine Rivers and tributaries - 78 cabins



MS Monet

MS Monet sails on the Danube and the Rhine Rivers and its tributaries.

Interior design



Cabins

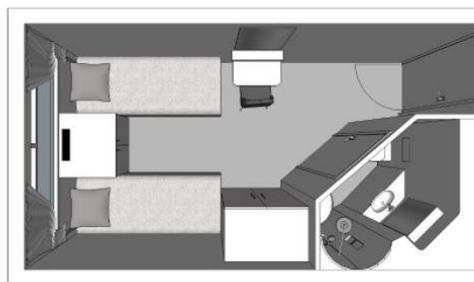

- Main Deck 1 double bed 10 m²
- Main deck 1 single bed 10 m²
- Main deck 2 beds 10 m²
- Main deck 3 beds 10 m²
- Upper Deck 1 double bed 10 m²
- Upper deck 2 beds 10 m²

Cabins equipments

- TV
- Telephone (for internal calls only)
- Bathroom with shower and toilet
- Towels
- Safe
- Independent air-conditioning
- Electricity 220V
- Wi-Fi

Please note that there is no laundry service on board the ship.

Decks and technical details

MAIN DECK 50 cabins

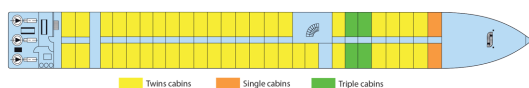

Year Built : 1999
Year Renovated : 2007
Guest capacity : 158
Number of cabins : 78
Width : 11.40
Length : 110
Number of decks : 2
Cabins outside

UPPER DECK 28 cabins

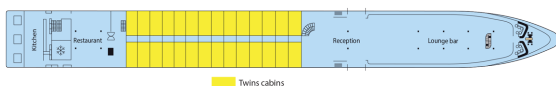

SUN DECK

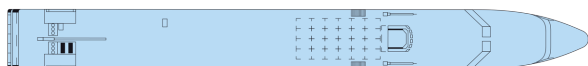

MAIN DECK : LIBRARY

UPPER DECK : RESTAURANT - RECEPTION DESK - LOUNGE BAR WITH DANCEFLOOR

SUN DECK : FITNESS - SUN DECK